

**Kenley Road
St Margarets
TW1 1JU**

£1,950

ChaseBuchanan

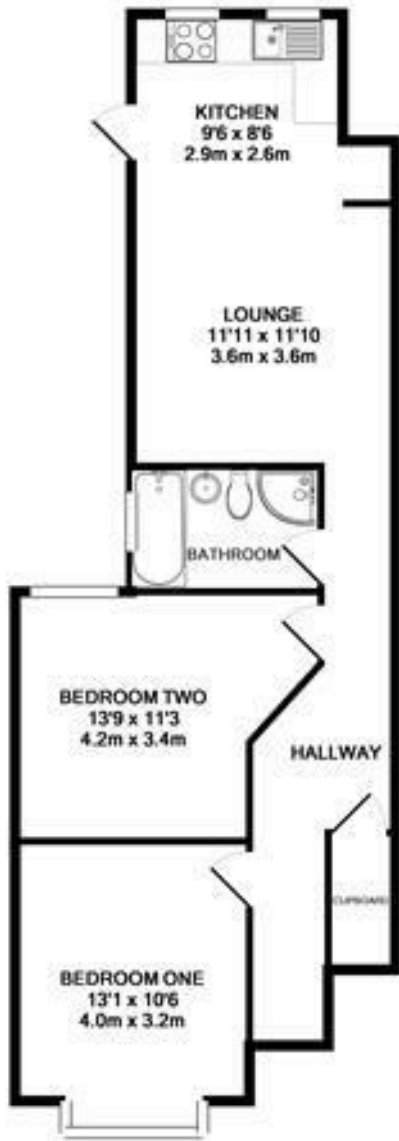



TOTAL APPROX. FLOOR AREA 688 SQ.FT. (62.1 SQ.M.)
 Made with Metropix ©2018

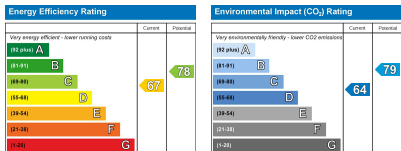

- Spacious ground floor maisonette
- Popular residential road
- Open plan living area
- Close to Moor Mead Park
- Two double bedrooms
- Presented in good decorative order
- Private rear garden
- EPC - D

Enjoy open plan living with this spacious two bedroom, ground floor maisonette. Set in one of St Margarets most popular residential roads and within just a short stroll to Moor Mead Park and St Margarets village shops and station. The property is presented in good decorative order and with the open plan living room and modern kitchen which has all integrated appliances, this creates two double bedrooms, rarely available with these maisonettes. There is also a modern bathroom with separate shower and the added benefit of a private decked rear garden.

Chase Buchanan are bonded members of ARLA PropertyMark.

For more information or to book a viewing, please contact:

020 8744 2888

ChaseBuchanan

124 St Margarets Road, St Margarets, TW1 2AA